

Da oggi l'impianto elettrico si incolla al muro.

**ISTRUZIONI DI POSA E MONTAGGIO**

MADE IN ITALY

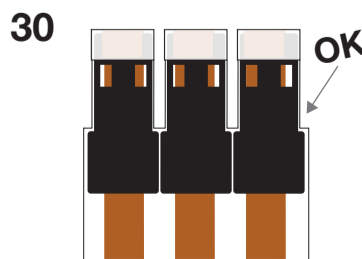
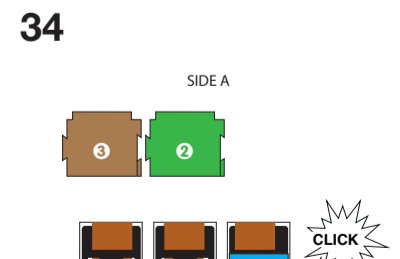
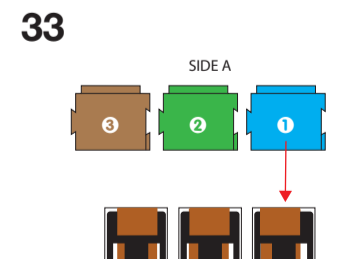
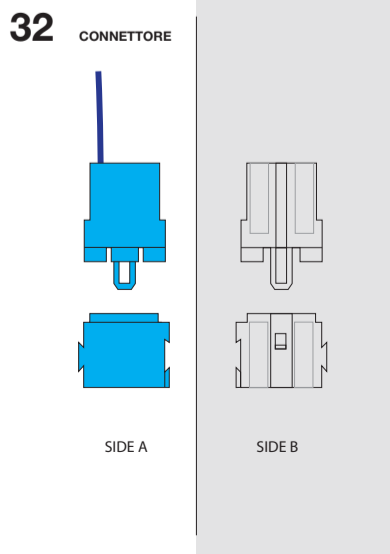
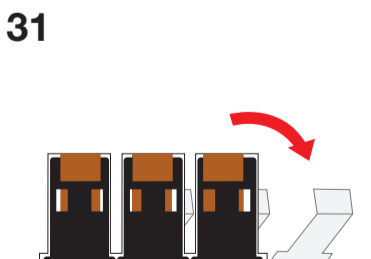
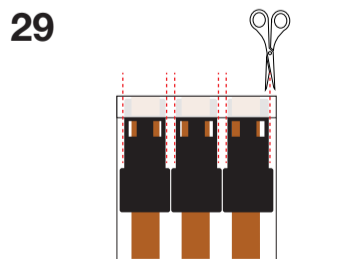
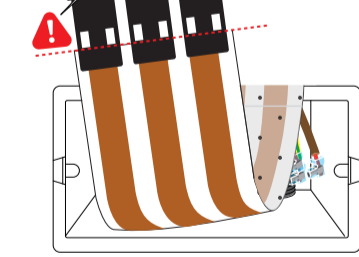
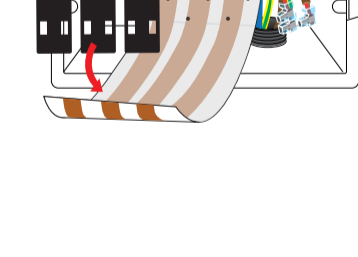
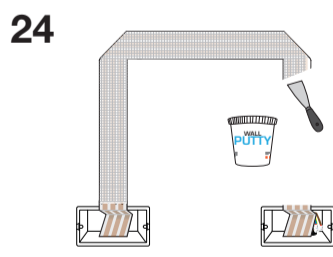
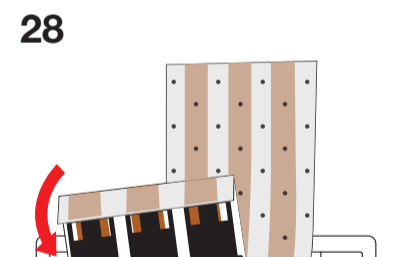
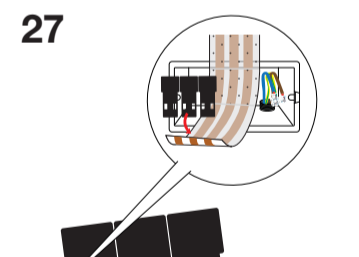
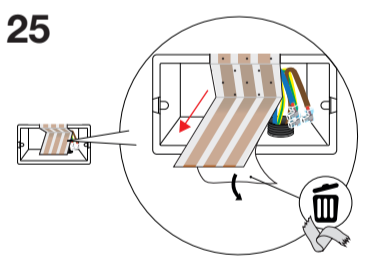
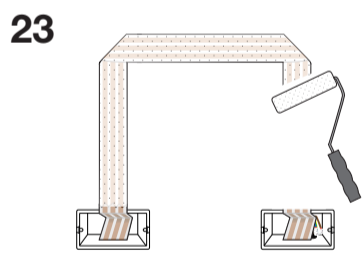
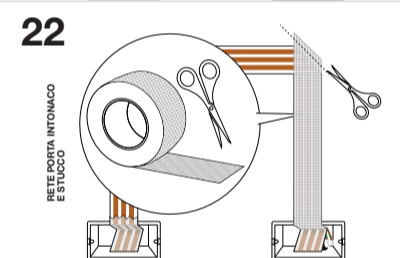
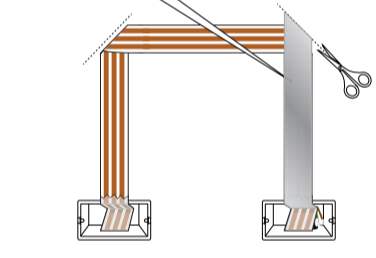
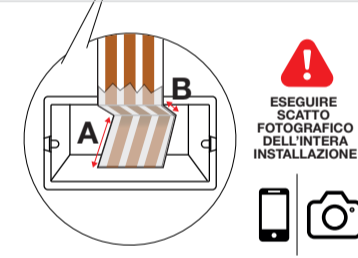
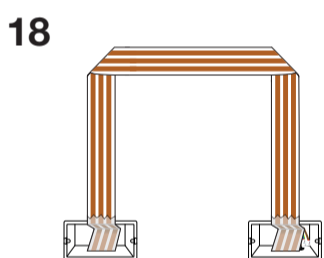
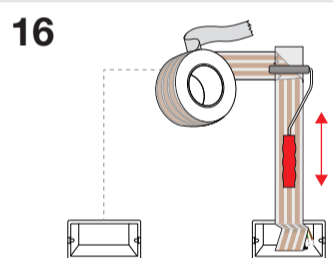
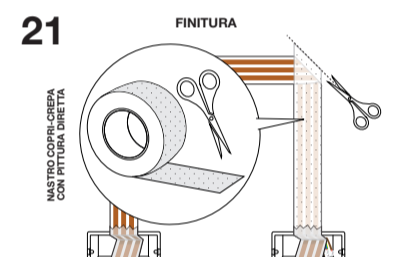
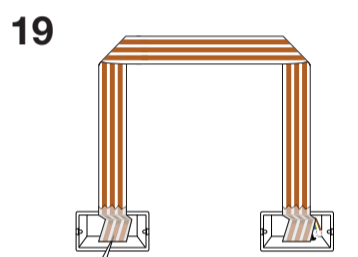
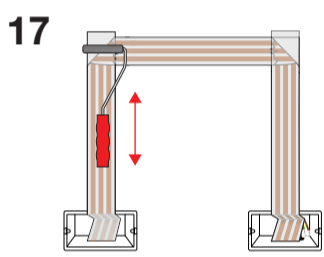
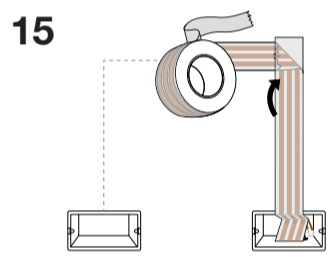
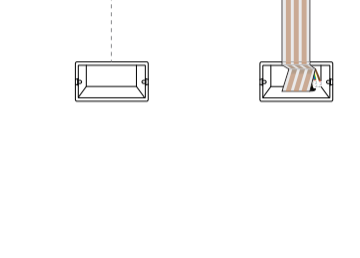
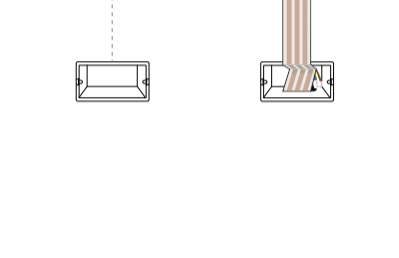
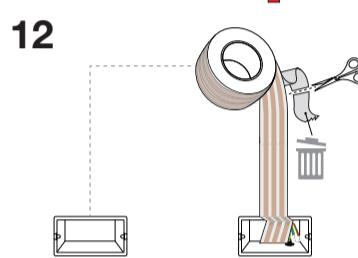
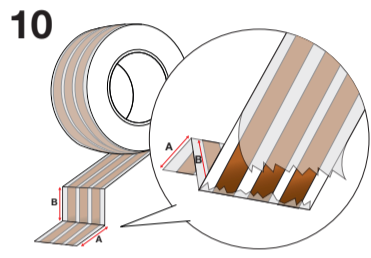
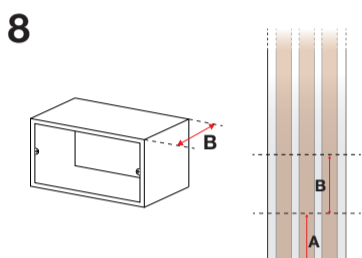
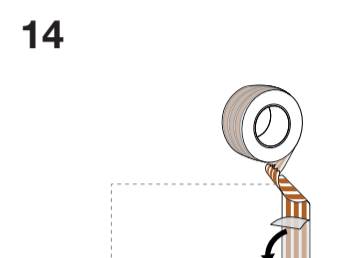
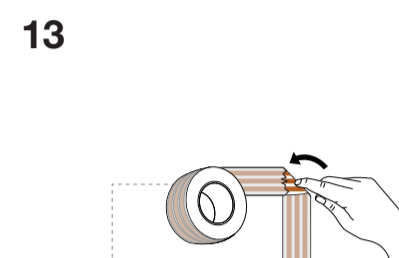
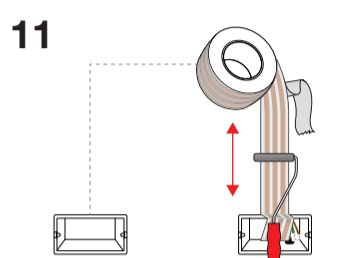
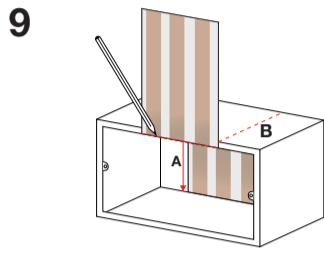
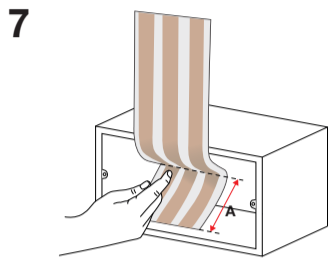
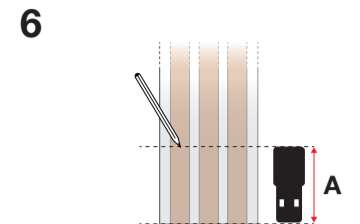
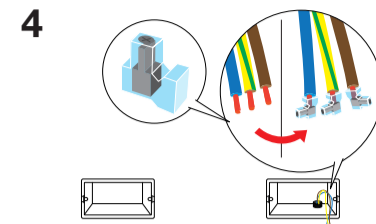
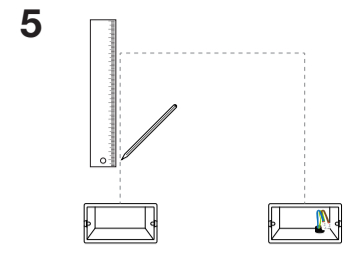
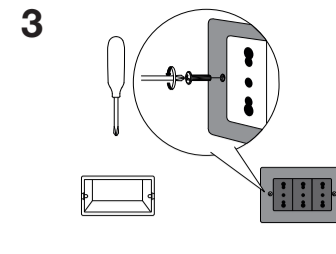
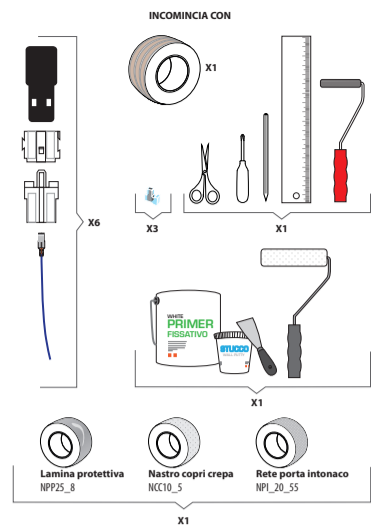

35

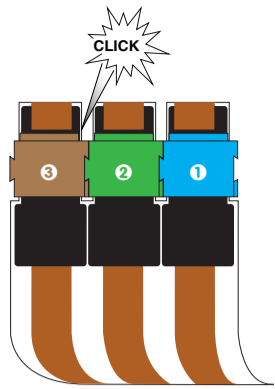

36

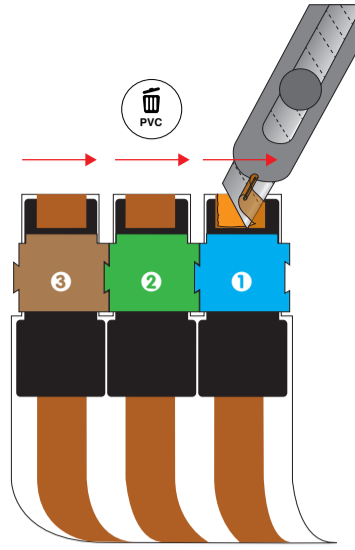

37

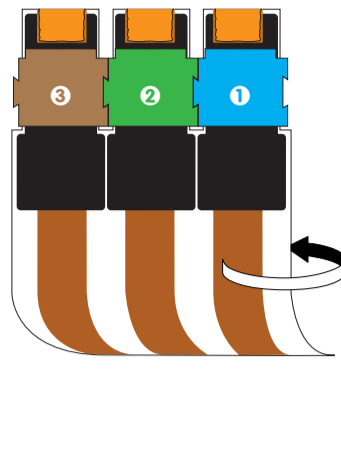

38

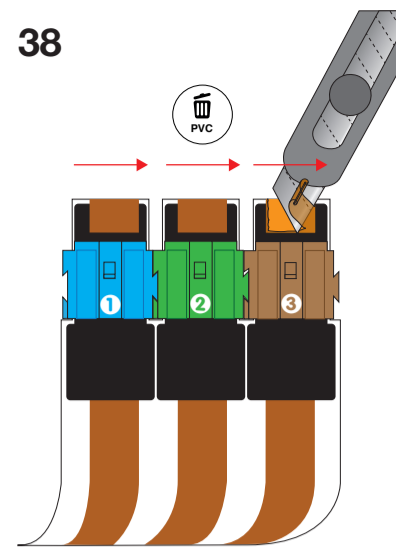

39

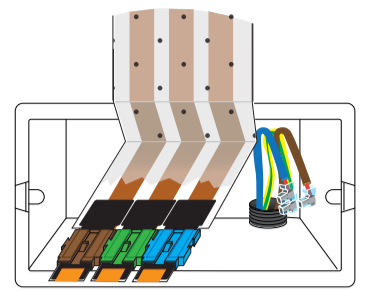

40

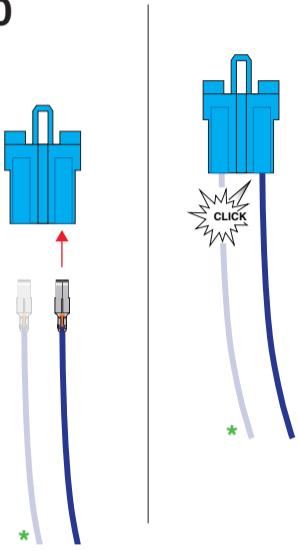

41

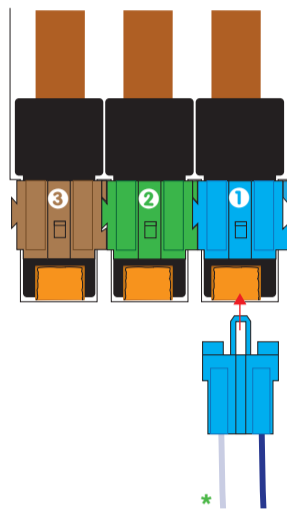

42

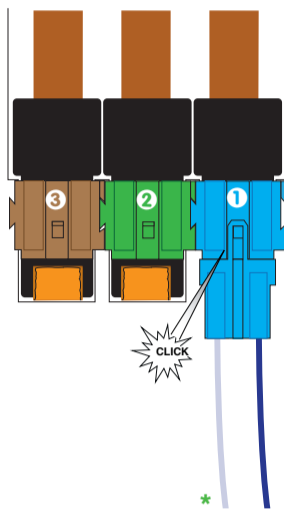

43

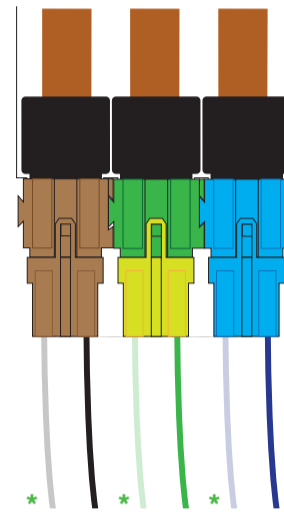

44

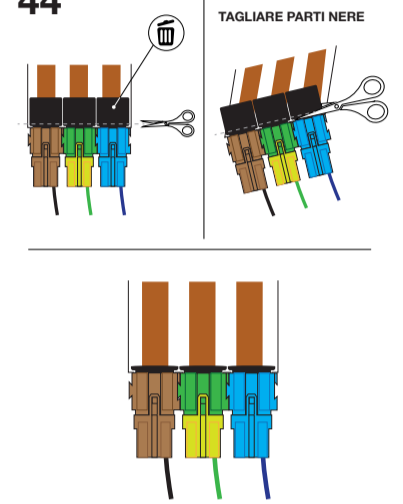

45

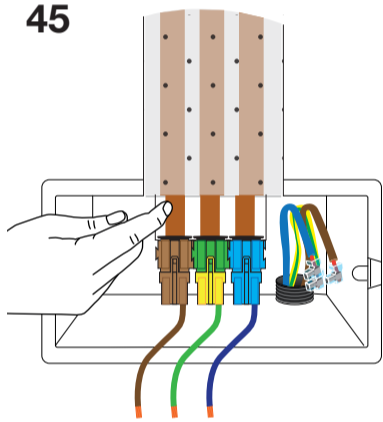

46

Applicare il codice QR code in uno dei connettori per identificare la tipologia di nastro utilizzato

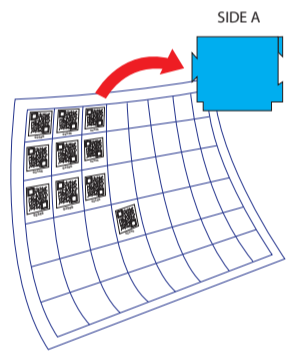

47



48

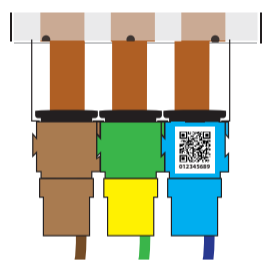

#### INFORMAZIONI GENERALI GENERAL INFORMATION

**CARATTERISTICHE PARTICOLARI**  
 Temperatura di stoccaggio e trasporto: -10°C/+50°C  
 Massima temperatura di impiego continuativo: +85°C  
 Umidità relativa massima @ Tamb=+55°C: 93%  
 Altitudine massima di impiego: 5.000m  
 Tensione nominale di isolamento, Ui: 1.500V AC  
 Tensione nominale di tenuta all'impulso: 5.000V  
 Densità di corrente nominale: 9A/mm<sup>2</sup> a 25°C

#### PARTICULAR CHARACTERISTICS

Warehousing and transport temperature: -10°C/+50°C  
 Maximum temperature of consecutive usage: +85°C  
 Maximum Humidity @ Tamb = +55°C: 93%  
 Maximum altitude: 5.000m  
 Insulation Voltage, Ui: 1.500V AC  
 Voltage resistance to the impulse: 5.000V  
 Voltage density: 9A/mm<sup>2</sup>

#### CONDIZIONI DI POSA

Temperatura ambiente minima durante la posa: +20°C  
 La superficie di installazione, per una corretta adesione del prodotto, dovrà essere asciutta e pulita da polveri o residui di lavorazione. A tale scopo si consiglia l'utilizzo di primer (primer NEXT o similar) per una garanzia di migliore aderenza / tenuta. Dovrà essere preliminarmente studiato e misurato il tratto di superficie sul quale verrà posto in opera il prodotto al fine di evitare la necessità di dover prolungare mediante giunti la linea posata. Il prodotto non può essere riposizionato.

#### APPLYING CONDITIONS

Minimum temperature for application: +20°C  
 First we recommend to study and measure the exact position where you want to install the product so mistakes can be avoided, be aware that this product cannot be applied more than once. To maximize adhesion the tape must be installed on an area that is dry and clean from powder and residuals. We recommend to use a primer substance (primer NEXT or something similar) to better guarantee it's adhesion/resistance.

#### IMPIEGO E TIPO DI POSA

Applicazione fissa a parete. A seguito della posa sul supporto, utilizzare un utensile idoneo (ad esempio un rullino in materiale plastico/gomma al fine di non danneggiare il prodotto installato), ed esercitare una leggera frizione omogenea su tutta la superficie del nastro al fine di migliorarne l'adesione ed eliminare tutte le eventuali bolle d'aria. Dove si intende effettuare una copertura mediante rasatura è richiesta l'applicazione di idonea retina protettiva prima di effettuare la rasatura stessa.

#### HOW TO APPLY AND RULES

After application, you need to make a light friction movement over the surface of the tape using an instrument, for example a plastic/rubber roll. This not only helps the adhesion but it also removes eventual air bubbles. Note: If you choose to cover the tape with any type of filling you will need to apply a protective net prior. For low tension application, after application we recommend to cover with correct material, to guarantee mechanical protection for the product, as for Normative applied in the country where the product is installed

#### OBBLIGHI E CONSIGLI UTILI OBLIGATIONS AND ADVICE

- PREPARAZIONE DELLE SUPERFICI.** Assicurarsi che la superficie della parete sia pulita, senza polvere e non umida prima di iniziare l'applicazione del nastro.
- APPLICAZIONE FISSA A PARETE.** Non riutilizzabile e non riapplicabile
- IN CASO DI DANNEGGIAMENTO DEL CAVO,** a causa di un chiodo, un taglio, un urto, ecc.. **OBBLIGO** di ripristino con kit Next oppure sostituzione del tratto di linea danneggiato.
- OBBLIGO DI PROTEZIONE DIFFERENZIALE,** solo per utilizzo in sistemi in bassa tensione da 50 a 1000 vca.
- OBBLIGO DI PROTEZIONE CON MAGNETOTER MICO o FUSIBILE** in presenza di un punto luce.
- OBBLIGO DI COPERTURA CON COLORE O ALTRA PROTEZIONE MECCANICA** fino a scomparsa visiva delle piste di rame.
- OBBLIGO DI PROTEZIONE MECCANICA ANTINPATTO CON RESISTENZA mini 6 joule,** sotto i mt 2,5.

CE

Temperatura di stoccaggio e trasporto: -10°C/+50°C  
 Temperatura ambiente minima durante la posa: +20°C  
 Massima temperatura di impiego continuativo: +85°C  
 Massima temperatura di impiego per brevi periodi: +105°C  
 Umidità relativa massima @ Tamb=+55°C: 93%  
 Altitudine massima di impiego: 5.000m  
 Tensione nominale di isolamento, Ui: 1.500V AC  
 Tensione nominale di tenuta all'impulso: 5.000V  
 Densità di corrente nominale: 9A/mm<sup>2</sup> a 25°C ta.

INSTALLARLO È SEMPLICISSIMO



GUARDA IL VIDEO!

#### \*

Con il nastro 1,5 mm<sup>2</sup> usare 1 cavo per ogni connettore

\* Con il nastro 2,5 mm<sup>2</sup> usare 2 cavi per ogni connettore

NEXT  
new energy tape



ADV: www.sphera.it

NEXT S.r.l.  
www.next-tape.com